

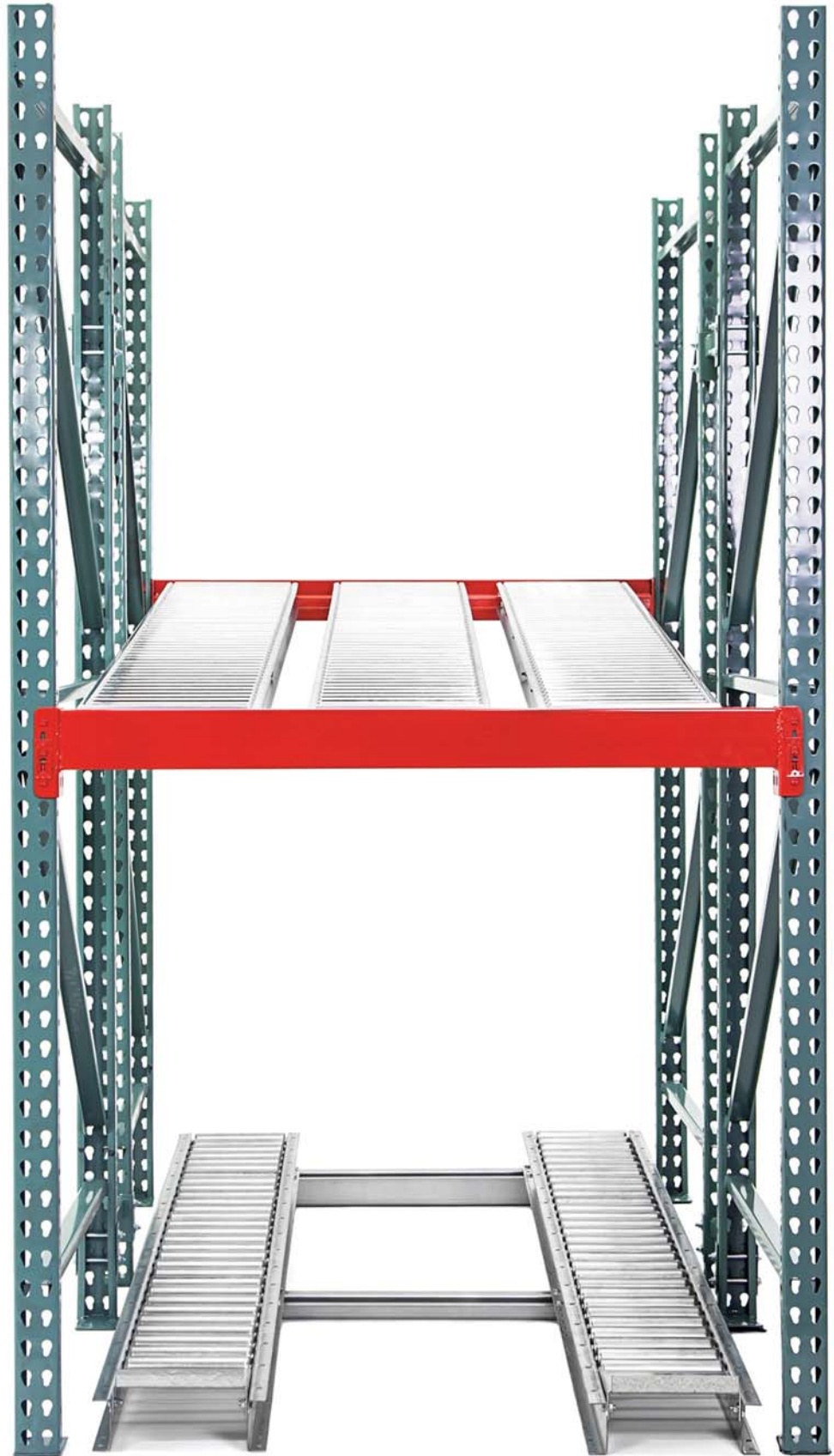

pallet//track

DYNAMIC
STORAGE
FOR PALLET
POSITIONS ON
THE PICK LINE



Pick Smarter. Pick Better. Pick UNEX.



Pallet Track Features & Benefits

- Creates a “First-In First-Out” (FIFO) storage system. Product is loaded from the rear and removed from the front.
- Can be floor mounted or supported by pallet rack beams
- Available in lengths from 24" to 144" in 1/2" increments
- Increased storage density
- Increased efficiency
- Reduced fork truck operations
- Reduced labor costs
- Reduced damage
- Green — uses no energy consumption

Wheel Track Features & Benefits

- Staggered wheel type flow rail is commonly used to handle “wrong way” GMA style wooden pallets (with bottom boards perpendicular to flow)
- Rails can be used in 2, 3, or 4 track configurations
- 2 deep pallet storage lanes come complete with ramp stops at discharge end to allow pallet to come to a controlled stop
- Available options include anti-backup stops and floor mount supports - available in custom lengths

Roller Track Features & Benefits

- Roller pallet track works well when handling single face pallets (no bottom boards, with 2 or 3 bottom stringers) or Euro style pallets with bottom boards parallel to flow, or plastic pallets with feet. They may also be used when heavier loads are being handled, as they can provide high load capacity per roller and greater contact area.
- Track Configuration of 2 or 3 tracks per pallet position
- 2 deep pallet storage lanes come complete with full width ramp stops at discharge end to allow pallet to come to a controlled stop
- Available options include floor supports, special end treatments for attaching to rack beams, and custom track lengths.

Specifications



PART NUMBER EXAMPLE - PALLET TRACK			
PT	MRS or SW	30	x96
SERIES	ROLLER TYPE	ROLLER CENTERS	TRACK LENGTH

Wheel Rail Specifications

- Standard 2-1/2" x 1" x 12 gauge galvanized channel
- Frame capacity of 210 lbs per ft when supported on 48" centers
- 1-1/2" staggered wheel centers provide maximum support and minimize indentation in wood pallets
- 1.9" diameter steel wheels on 1/4" diameter axle are rated at 100 lbs capacity each

PALLET TRACK WHEEL	
CONFIGURATION	CAPACITY
2 Rail	3360 lbs
3 Rail	5040 lbs
4 Rail	6720 lbs

210 lbs per ft, per rail at 48" unsupported, based on rail length of 96"

Roller Specifications

- Standard 3-1/2" x 1-1/4" x 12 gauge galvanized steel
- Frame capacity of 500 lbs per ft when supported on 48" centers
- Optional roller centers from 2" and up, depending on load — 1.9" x 16 gauge galvanized steel roller with 7/16" hex axle is rated at 170 lbs capacity each

PALLET TRACK ROLLER	
CONFIGURATION	CAPACITY
2 Track	8000 lbs
3 Track	12000 lbs

500 lbs per ft, per rail at 48" unsupported, based on rail length of 96"

SW RAIL PALLET FLOW

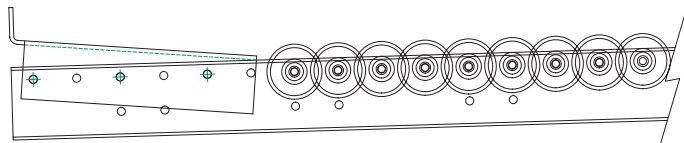
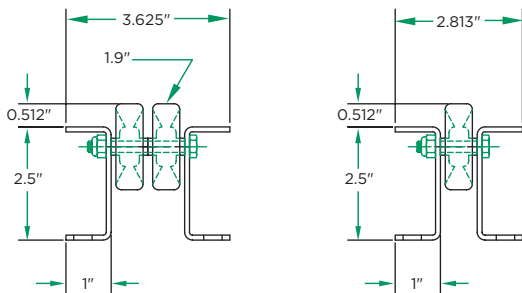

MRS PALLET FLOW

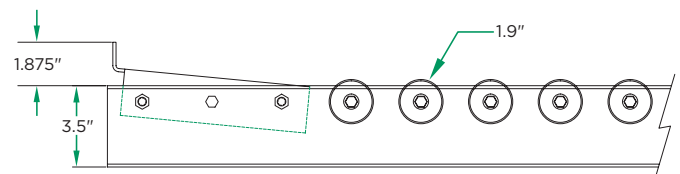
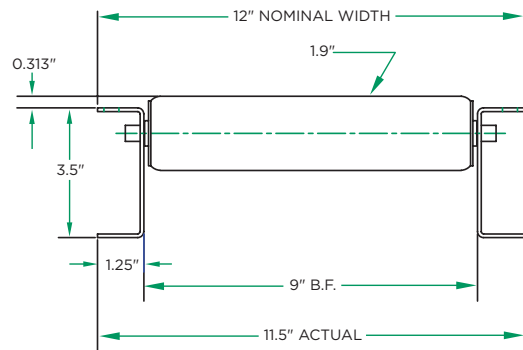



◀ **Rail Support Mount** ▶
For floor mounted applications

◀ **Anti backup** ▶
For wheel rail



ANTI BACKUP FOR WHEEL RAIL

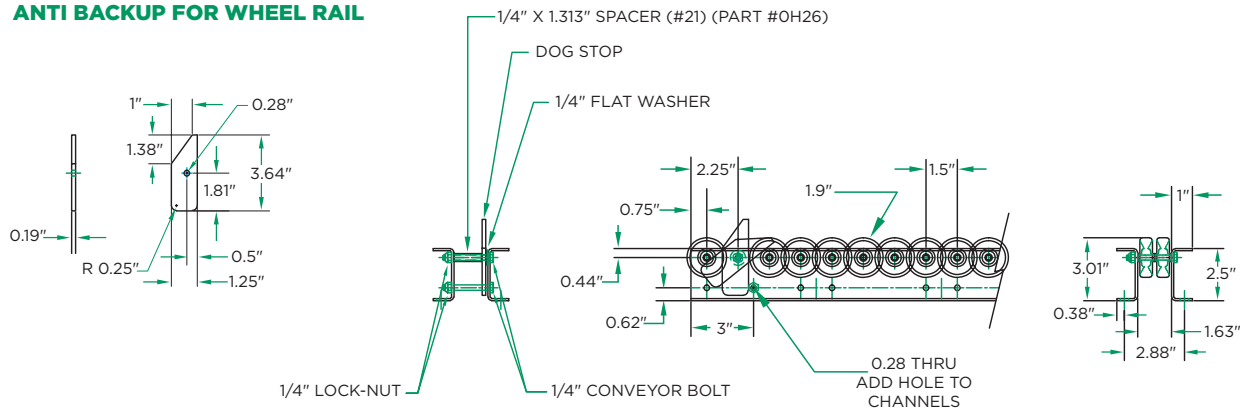

RAIL SUPPORT MOUNT

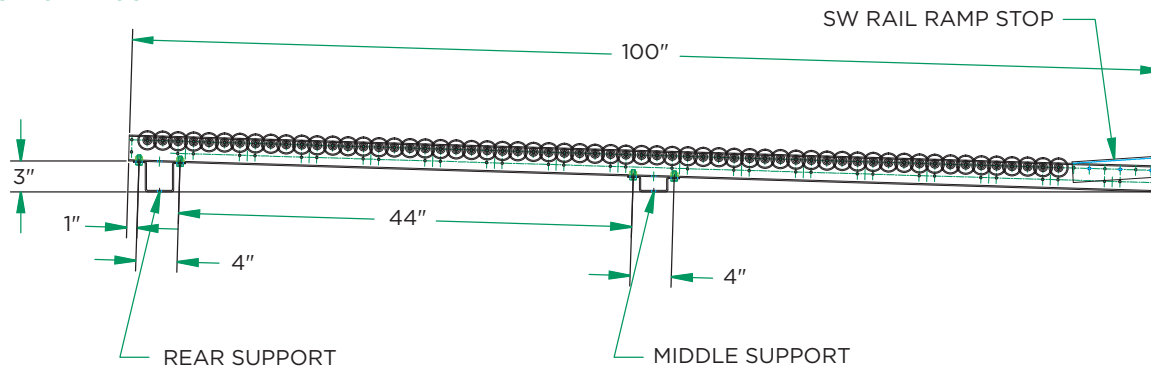

Pick **Smarter.**
Pick **Better.**
Pick **UNEX.**



UNEX MANUFACTURING, INC.
50 Progress Place, Jackson, NJ 08527

800.695.SPAN (7726)

732-928-2800 • fax: 732-928-2828 • e-mail: span@unex.com



unex.com